

LINE	BEARING	DISTANCE	LINE	BEARING	DISTANCE
L1	N 64°38'19" W	15.51'	L38	N 50°23'19" W	137.10'
L2	N 64°38'19" W	5.46'	L39	N 32°48'17" W	119.19'
L3	N 44°28'48" W	41.04'	L40	N 14°11'21" W	75.03'
L4	N 28°08'02" W	76.24'	L41	N 16°58'44" E	151.68'
L5	N 21°13'01" W	77.17'	L42	N 05°59'34" E	75.04'
L6	N 28°02'05" W	75.71'	L43	N 12°22'08" E	152.66'
L7	N 48°11'11" W	75.89'	L44	N 02°36'32" W	76.43'
L8	N 51°23'26" W	76.93'	L45	N 28°58'43" W	70.78'
L9	N 43°55'48" W	77.92'	L46	N 56°29'16" W	151.73'
L10	N 36°14'43" W	75.51'	L47	N 36°37'46" W	52.50'
L11	N 29°30'34" W	77.80'	L48	N 37°58'53" W	100.13'
L12	N 27°13'32" W	75.81'	L49	N 70°02'35" W	307.19'
L13	N 26°56'36" W	75.65'	L50	N 80°35'24" W	50.11'
L14	N 22°42'33" W	77.13'	L51	S 75°25'19" W	150.71'
L15	N 21°36'30" W	77.23'	L52	N 87°38'58" W	75.79'
L16	N 50°49'19" W	49.84'	L53	N 29°23'20" W	81.88'
L17	N 83°57'49" W	75.56'	L54	N 11°30'18" W	75.08'
L18	N 79°37'18" W	76.95'	L55	N 43°38'14" W	27.81'
L19	S 89°03'39" W	75.69'	L56	N 35°30'34" E	103.74'
L20	S 78°13'24" W	76.78'	L57	N 10°06'23" W	150.48'
L21	S 89°27'56" W	76.07'	L58	N 16°42'43" E	111.12'
L22	S 87°08'24" W	75.92'	L59	N 03°04'51" E	40.99'
L23	S 76°16'16" W	76.94'	L60	N 07°41'59" W	75.79'
L24	S 86°13'52" W	75.63'	L61	N 04°11'07" W	89.80'
L25	S 74°11'52" W	75.35'	L62	N 22°18'19" E	73.16'
L26	S 52°18'47" W	75.94'	L63	N 48°48'40" E	228.66'
L27	S 39°52'57" W	75.25'	L64	N 39°08'59" E	158.87'
L28	S 51°19'33" W	80.27'	L65	N 56°43'34" E	66.32'
L29	S 89°48'24" W	77.25'	L66	N 37°49'01" E	413.14'
L30	N 63°19'14" W	76.24'	L67	N 07°26'21" E	137.80'
L31	N 74°36'25" W	145.34'	L68	N 04°47'09" W	135.64'
L32	N 80°28'44" W	76.75'	L69	N 03°05'16" E	176.58'
L33	N 82°09'42" W	75.24'	L70	N 00°38'21" E	32.18'
L34	N 76°54'54" W	95.30'	L71	N 18°49'13" W	122.42'
L35	N 85°06'16" W	223.45'	L72	N 32°36'02" E	82.29'
L36	S 88°04'38" W	152.36'	L73	N 79°34'49" E	25.59'
L37	N 77°23'54" W	74.12'	L74	N 00°19'27" E	95.16'

Plat of a survey of Real Property and Improvements situated on a 624.526 acre tract of land consisting of: 430.915 acres being out of and part of the Gabriel Padillo Survey, Abstract No. 285, Callahan County, Texas; 20.125 acres out of and part of the Chicago, Texas, and Mexican Central Railway Company Survey No. 1, Abstract No. 1291, Callahan County, Texas; 83.919 acres out of and part of the W. Boren Survey, Abstract No. 952, Callahan County, Texas; and 89.567 acres out of and part of the Lavaca County School Land Survey No. 6, Abstract No. 262, Callahan County, Texas.

NOTE:
 Property subject to following Right of Way's and or Easements as per Security Abstract & Title Company of Abilene Commitment GF No. 16-52781:
 * Kasle Energy, Inc. 30.00' wide Access Easement (shown on Plat) Document No. 162288, Official Public Records, Callahan County, Texas.
 * MJFTX, LLC. 30.00' wide Access Easement (shown on Plat) Document No. 162290, Official Public Records, Callahan County, Texas.
 * West Cen-Tex Gas Company, called 40.00' wide Right of Way (shown on plat) Cause No. 12973, District Court Records, Callahan County, Texas.
 * Abraham Conejo and Maria Conejo, 30.00' wide Access Easement (shown on Plat) Document No. 161283, Official Public Records, Callahan County, Texas.

LEGEND:

I, David Williams, Registered Professional Surveyor No. 6502, do hereby certify to Security Title Company of Eastland, Texas and Ronald and Debra Cantu, that this plat correctly represents the facts found on the ground at the time of survey and that this professional service conforms to the current Texas Society of Professional Surveyors Standards and Specifications for a Category 1A, Condition III Survey.

David Williams
 Registered Professional Surveyor No. 6502
 12/01/2016

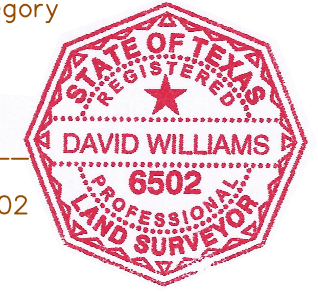

FLOOD HAZARD STATEMENT:
 The Property and improvements described above located in an unincorporated and unmapped area of Callahan County, Texas as published by the Department of Housing and Urban Development, Federal Insurance Administration. (fema.gov)

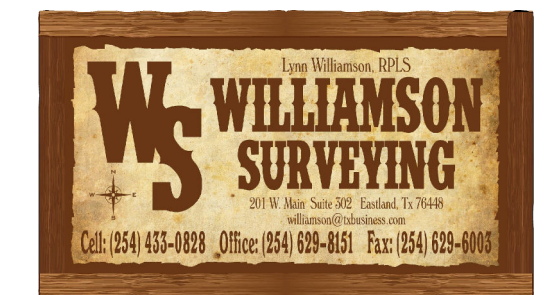

JB9184DW, 12/01/2016, RONALD AND DEBRA CANTU
 SCALE: 1" = 400'
 0 400' 800' 1200'